



EW22001

Power Steering Fluid Exchange Tool Box

JOB AID

Technical Support:
833-303-4644

SAFETY RECOMMENDATIONS

Use extreme safety measures when working around a running engine.

Always block the vehicle's drive wheels.

Ventilate the vehicle's exhaust.

Always wear safety glasses.

It's a good idea to wear gloves.

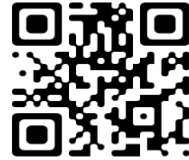

PREPARATION

Check the fluid level and quality.

Road test the vehicle for at least one mile.

Make sure that there are no problems with the power steering system such as leaks, belt slippage or excessive noise.

Connect battery cables to vehicle's battery.

Position and secure both lines, using clamp, into the power steering fluid reservoir, with the **USED FLUID** line positioned at or near max (Full) and the **NEW FLUID** Line at the bottom of the reservoir.

Make sure hose ball valves are in the open position.

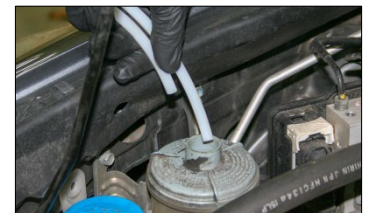

Attach **NEW FLUID** cap / inlet tube to bottle of Wynn's Power Steering Cleaner.

Make sure **USED FLUID** bottle is empty & attach to **USED FLUID** cap/inlet tube.



PERFORMING SERVICE

Start the vehicle's engine.

Turn both the **NEW** and **USED FLUID** pumps **ON** to begin service. The fluid level in the vehicle's power steering reservoir should remain unchanged during service. Ball valves at adapters are only used to turn flow on or off.

Monitor the Power Steering fluid level, if the reservoir begins to overfill, turn the **NEW FLUID** switch to **OFF**, allow fluid level to return to normal and return the **NEW FLUID** switch to **ON**. Continue to monitor fluid level, you may need to take this action again before service is complete.

NOTE: Flow rates are balanced from the factory and will not usually require adjustment.

When the Power Steering Cleaner bottle is empty, turn **OFF** both pumps.

Turn the steering wheel lock to lock for **10 minutes** to circulate the Cleaner throughout the system.

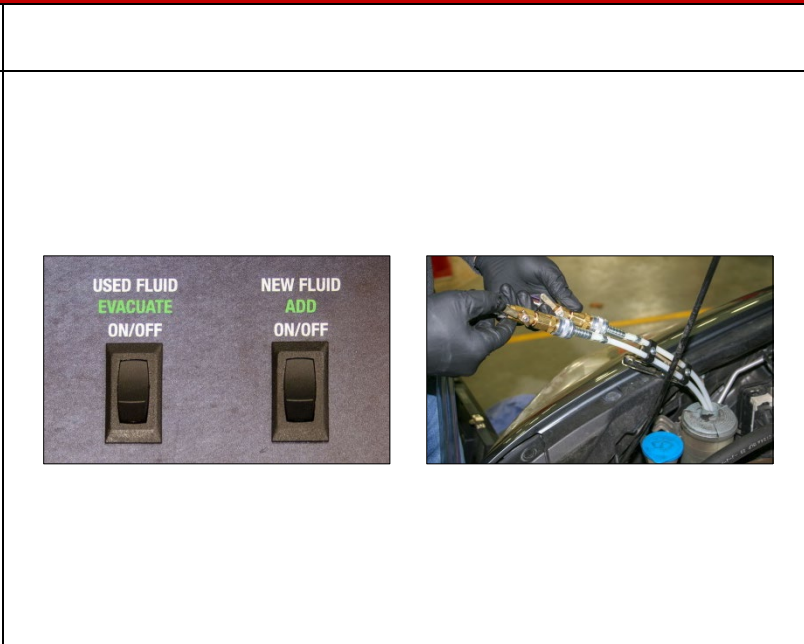

Attach **NEW FLUID** cap/inlet tube to bottle of Wynn's Power Steering Fluid.

Make sure **USED FLUID** bottle is empty & attach to **USED FLUID** cap/inlet tube.

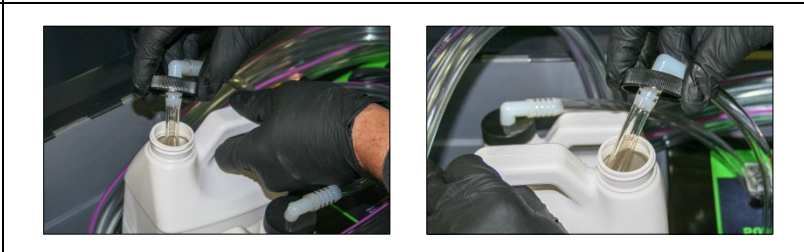

Turn both the **NEW** and **USED FLUID** pumps **ON** to begin service. The fluid level in the vehicle's power steering reservoir should remain unchanged during service. Ball valves at adapters are only used to turn flow on or off.

Monitor the Power Steering fluid level, if the reservoir begins to overfill, turn the **NEW FLUID** switch to **OFF**, allow fluid level to return to normal and return the **NEW FLUID** switch to **ON**. Continue to monitor fluid level, you may need to take this action again before service is complete.

NOTE: Flow rates are balanced from the factory and will not usually require adjustment.

Turn the steering wheel lock to lock several times throughout the exchange process.

When the fluid is clean (or service kit bottle is empty), turn **OFF** both fluid pumps.

NOTE: When adding an additive at the end of the exchange, leave the necessary space in the reservoir.

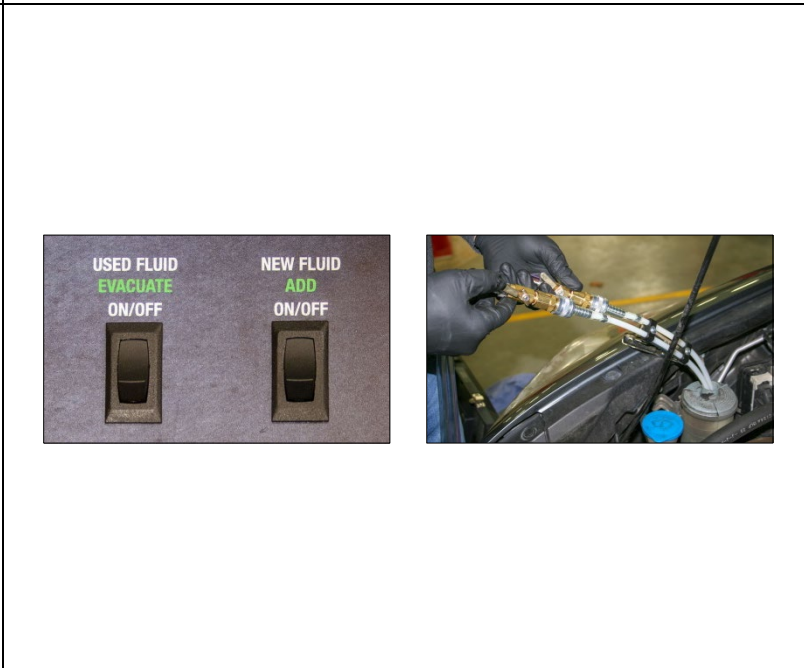



EW22001
Power Steering
Fluid Exchange Tool Box

JOB AID
Technical Support:
833-303-4644

Turn off engine, disconnect battery cables, and replace reservoir cap (and screen if applicable).



EXCHANGE USING SINGLE TUBE Y-ADAPTER

Position and secure the included single tube Y-adapter into the power steering fluid reservoir.
Make sure hose ball valves are in the open position.
Start the vehicle's engine.



Set the **USED FLUID** switch to the **ON** position to drain the power steering fluid reservoir, leaving enough on the bottom to prevent air from entering the lines. Set the switch to the **OFF** position.
Set the **NEW FLUID** switch to the **ON** position. Once the reservoir is filled to the proper level, set the switch to the **OFF** position.
Turn the steering wheel lock to lock several times, and repeat drain/fill and turning steering wheel until the fluid is clean (or service kit bottle is empty).
NOTE: When adding an additive at the end of the exchange, leave the necessary space in the reservoir.



Turn off engine, disconnect battery cables, and replace reservoir cap (and screen if applicable).

